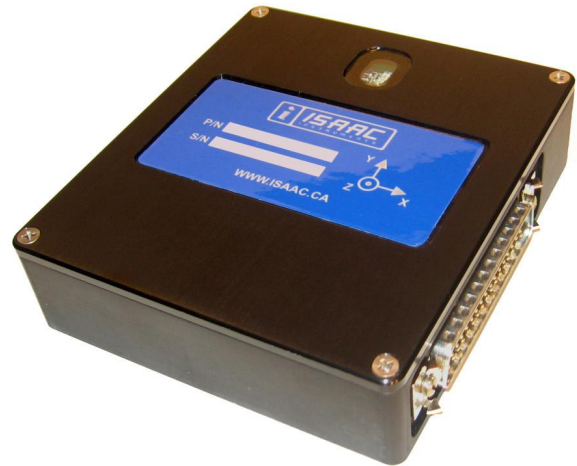

Features

- Stand-alone data recorder for mobile applications
- 512 MBytes of memory, with data retention in case of power loss
- 8 external inputs: analog, frequency, counters or state
- 5 internal sensors:
 - 3 internal accelerometers: $\pm 2G$ or $\pm 6G$
 - Internal Temperature
 - Supply Voltage
- 3 Vehicle data bus ports
 - CAN1: CAN 2.0a/b (HS-CAN)
 - CAN2: CAN 2.0a/b (HS-CAN – see other options below)
 - SAE-J1708/SAE-J1587
- 3 RS-232 serial ports (COM)
- Compatibility with:
 - COMGPS - GPS receiver with antenna
 - COMEVD - CDMA cellular network transceiver
 - COMETH - Ethernet communication module
 - COMBLU - Bluetooth radio transceiver
 - COMMH1 - 900 MHz long range radio transceiver
 - COMGSM - GPRS (GSM) cellular network transceiver.
 - COMWFI - Wi-Fi communication module
 - VDPMOD-OBD - Connect to all OBD compatible vehicle data bus (J1850PWM, J1850VPW, ISO9141-2, ISO 14230 KWP, ISO15765 - CAN)
- Recording triggered by input - automatic start/stop
- Sampling rate up to 4 kHz for all external channels
- 1 USB 2.0 full-speed port.
- Low power consumption and auto shutdown
- Small size, light weight, rugged anodized aluminum enclosure resistant to petroleum products
- Built-in overvoltage protection circuit
- Vibration Lock™ connector, no tools required
- MIL-STD-810F, CE and IP65

Options

OPTVD2	Vehicle Data bus option 2 <ul style="list-style-type: none"> – CAN1: CAN 2.0a/b (HS-CAN) – CAN2: CAN 2.0a/b (FT-CAN) – SAE-J1708/SAE-J1587
OPTVD3	Vehicle Data bus option 3 <ul style="list-style-type: none"> – CAN1: CAN 2.0a/b (HS-CAN) – CAN2: CAN 2.0a/b (SW-CAN) – SAE-J1708/SAE-J1587

Installation
Hardware setup:

- Attach the Recorder to the vehicle chassis using Dual-Lock™ Velcro
- Position the Recorder such that the three LEDs indicating the system status are visible
- Align the Recorder's X, Y and Z axis along the lateral, longitudinal and vertical orientation of the vehicle
- Use the main recorder harness (HRNMN2-318) to connect the Recorder to the power supply and peripherals

Software Configuration:

Use Analyzer V9 software to configure or retrieve data from the Recorder.

Calibration

The calibration data for the three internal accelerometers is supplied with the Recorder.

CAN SWCAN Interface (Philips AU5790) Bit Rate DC voltage at pin CANH Transient voltage at pin CANH	BR_{SWCAN} V_{SWCANH} $V_{tSWCANH}$	10 -10 -100	33	100 18 100	Kbit/sec V V
SAE J1708 Interface (National DS36277) Bit rate DC voltage at pin A DC voltage at pin B	BR_{J1708} V_{J1708A} V_{J1708B}	-10 -10	9.6	15 15	kbit/sec V V
Effective download throughput USB COM1, COM2, COM3 (RS-232)			530 10		KBytes/sec kBytes/sec
Environment Operating temperature Storage temperature	T_o T_s	-40 (-40) -40 (-40)		85 (185) 85 (185)	C (F) C (F)
Certifications Electromagnetic compatibility IP (Ingress protection) (IEC 60529) Environmental (military spec.)	CE IP 65 MIL-STD 810F MIL-STD 810F MIL-STD 810F MIL-STD 810F MIL-STD 810F IEC 68-2-52	CE Mark IP 65 (dust & waterproof) 501.4 (low temperature) 502.4 (high temperature) 507.4 (humidity) 514.5 (vibration) 516.5 (mechanical shock) Resistance to Cyclic Salt Spray			
Mechanical Specifications Height Depth Width Weight			28.8 (1.14) 98.4 (4.00) 111.1 (4.38) 260 (9.17)	mm (in) mm (in) mm (in) g(oz)	

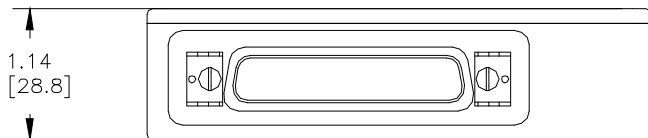
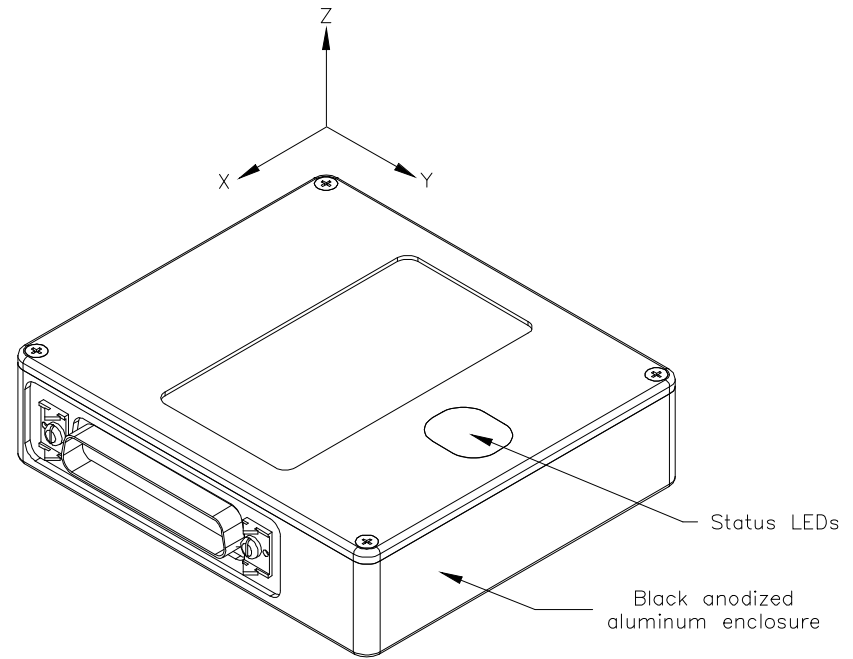
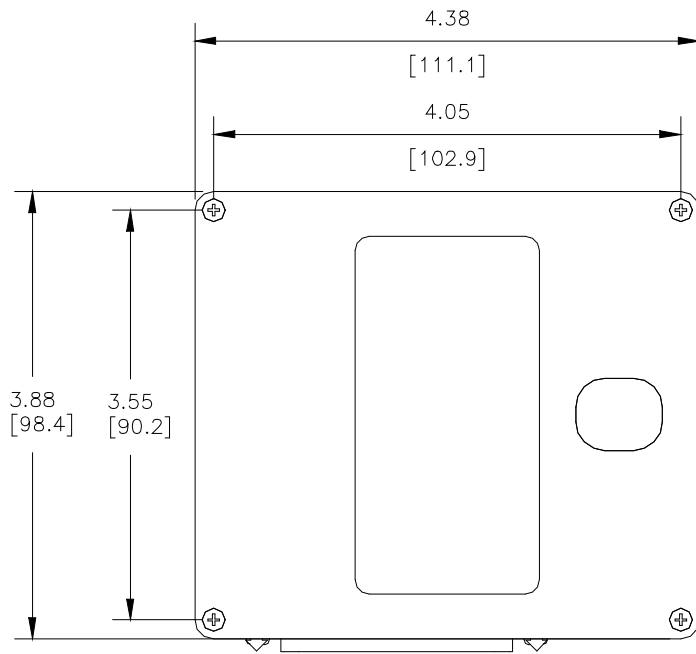

All dimensions are in inches [millimeters].